

The Maltings Theatre and Arts Centre

Eastern Lane
Berwick-upon-Tweed
Northumberland TD15 1AJ



Telephone: 01289 330661
Fax: 01289 331367
Email: admin@maltingsberwick.demon.co.uk
Web: www.maltingsberwick.co.uk

CONFERENCE AND ROOM HIRE

There are several different spaces in The Maltings suitable for a variety of conference activities:

The **MAIN AUDITORIUM** has raked stalls seating for up to 258 and 6 additional wheelchair and disabled places. The balcony seats 54 plus 13 removable seats creating wheelchair spaces.

The **MAIN HALL** is a large (13.67m x 12.4m) light and airy room with excellent views across the River Tweed. There is level access from the Theatre Foyer, and a sprung wooden floor suitable for dance and other activities. Bar facilities can be set up here if required.

On the lower floor there are two basic, serviceable **MEETING ROOMS** accessible via the main stairs or passenger lift. The largest (7.92m x 4.42m) seats up to 16 and the smaller (6.35m x 3.4m) up to 10 people.

The **THEATRE BAR** (9.14m x 8m) can also be used for small scale meetings and presentations.

The **CRAFT ROOM** (8.23m X 5.94m) is in the basement, though with outside windows and plenty of light. It is accessible via passenger lift from the Foyer. It is a workshop space with sink and multiple power points.

In addition we can provide the basic equipment to make your meeting a success:

- Large and sturdy folding tables
- Chairs
- Television
- Video player
- DVD player
- Overhead Projector
- Screen
- Flip charts

CATERING

Coffee, tea and snacks can be arranged through our café, heights. Direct Telephone – 01289 309333

PARKING

A public pay and display Car Park is adjacent to The Maltings, with maximum waiting time of two hours. Additional all day parking is available at the Quayside, just 5 minutes walk away.

ACCESS

Access to the foyer is via steps or a ramp from the car park. Disabled facilities and meeting rooms are accessed by stairs or passenger lift.

RATES FOR HIRE vary according to customer's requirements. Please contact us for a chat about your requirements. Enquiries should be directed to the administration office. EMail admin@maltingsberwick.demon.co.uk or call 01289 330661

The Maltings Theatre and Arts Centre

Eastern Lane
Berwick-upon-Tweed
Northumberland TD15 1AJ



Telephone: 01289 330661
Fax: 01289 331367
Email: admin@maltingsberwick.demon.co.uk
Web: www.maltingsberwick.co.uk

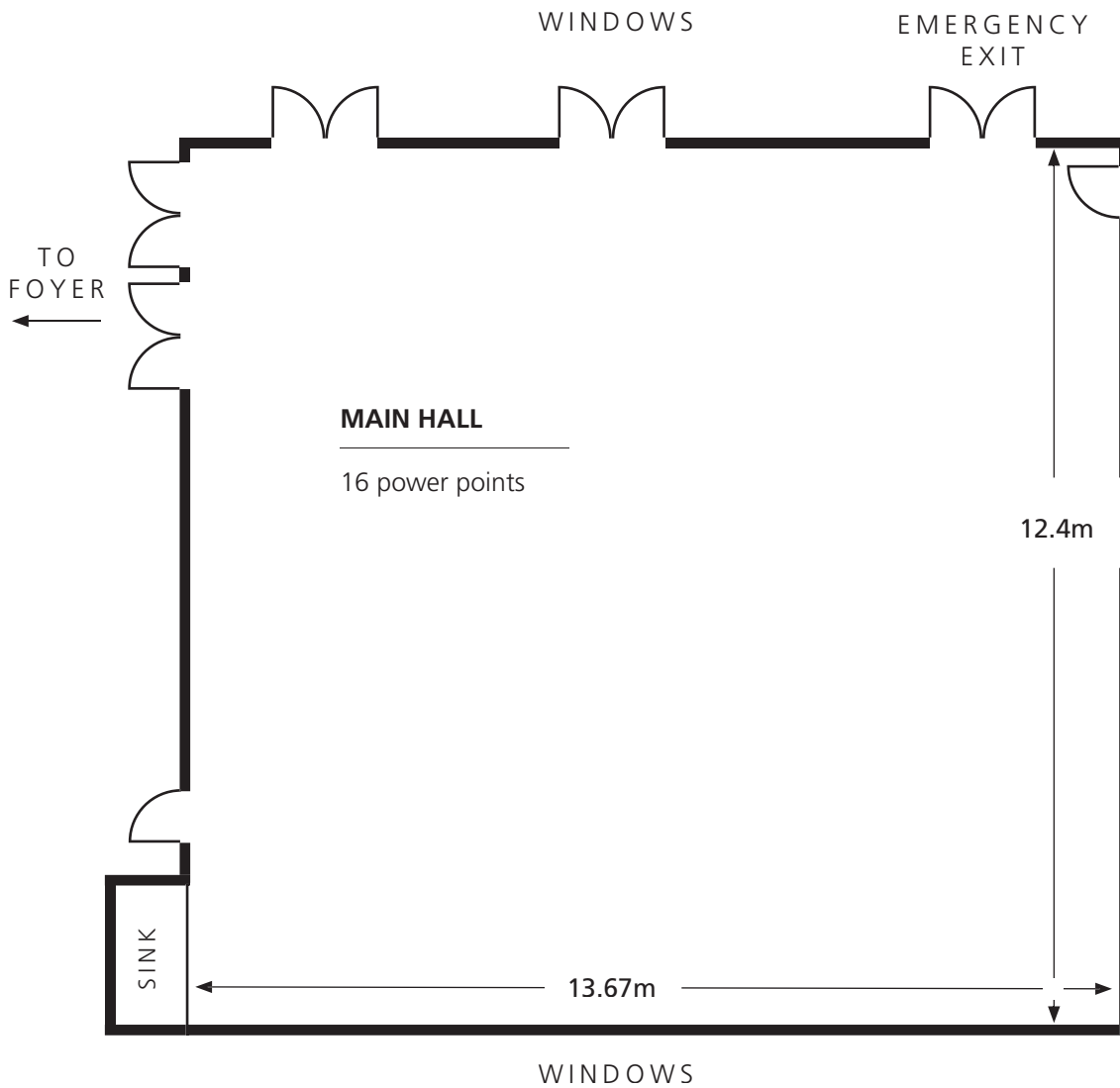

The Maltings Theatre and Arts Centre
Eastern Lane
Berwick-upon-Tweed
Northumberland TD15 1AJ



Telephone: 01289 330661
Fax: 01289 331367
Email: admin@maltingsberwick.demon.co.uk
Web: www.maltingsberwick.co.uk

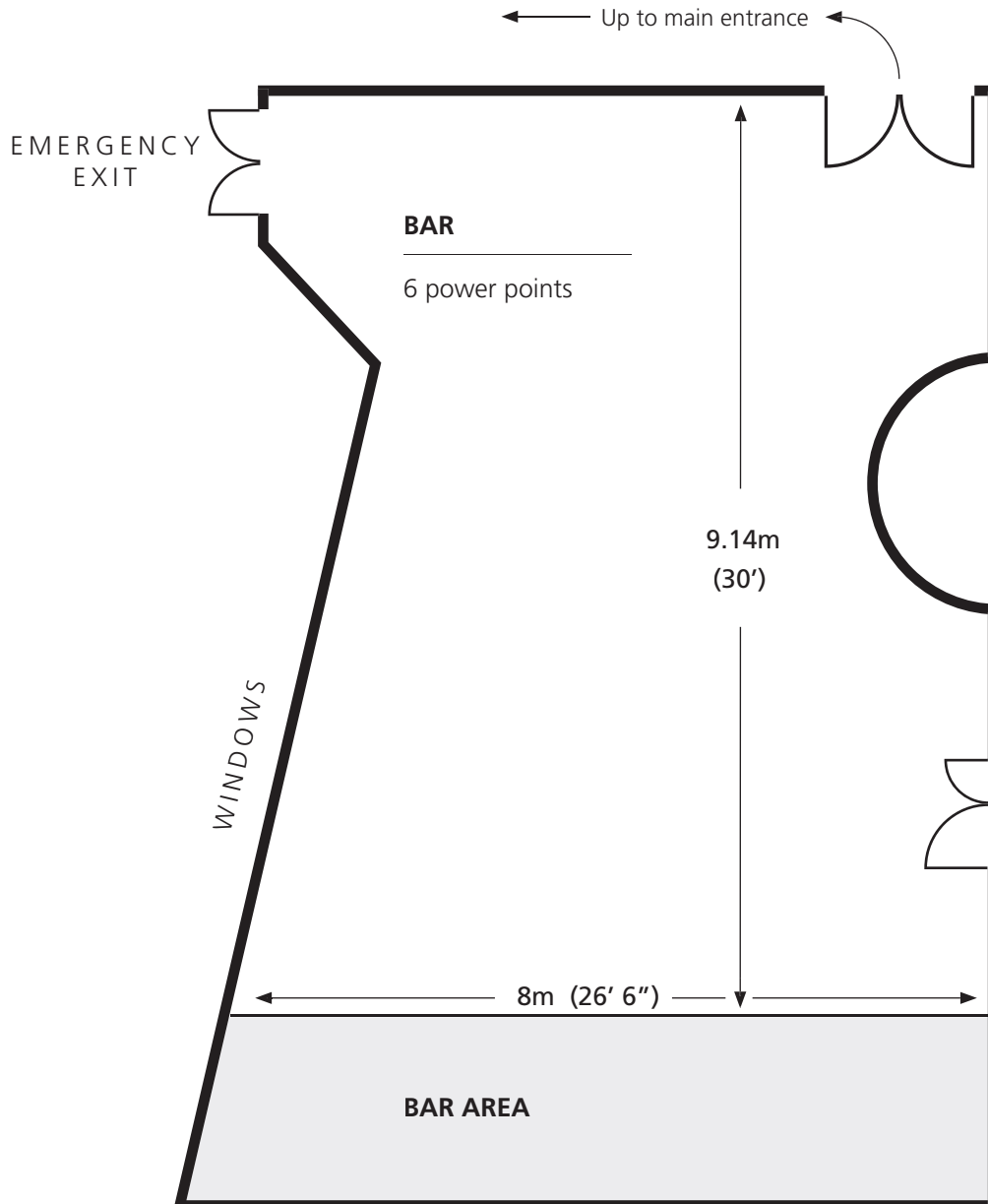

The Maltings Theatre and Arts Centre
Eastern Lane
Berwick-upon-Tweed
Northumberland TD15 1AJ

Telephone: 01289 330661
Fax: 01289 331367
Email: admin@maltingsberwick.demon.co.uk
Web: www.maltingsberwick.co.uk

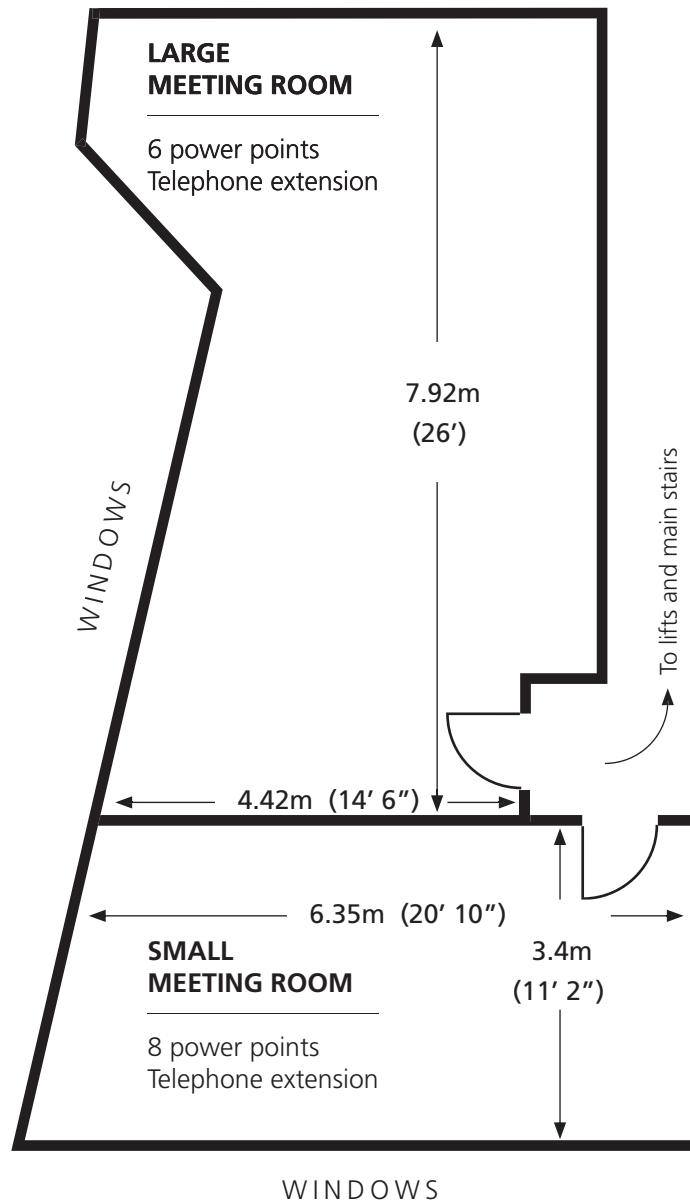

The Maltings Theatre and Arts Centre
Eastern Lane
Berwick-upon-Tweed
Northumberland TD15 1AJ

Telephone: 01289 330661
Fax: 01289 331367
Email: admin@maltingsberwick.demon.co.uk
Web: www.maltingsberwick.co.uk

